

ROTATOR GIR12-05

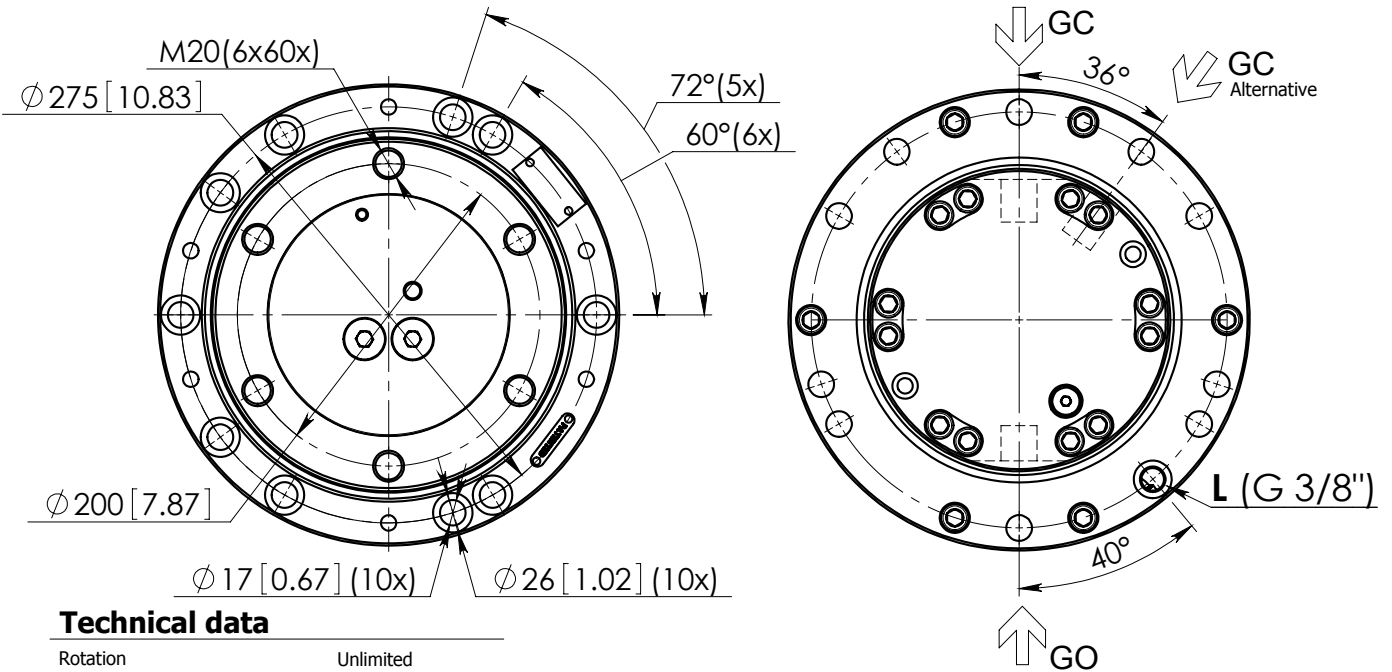
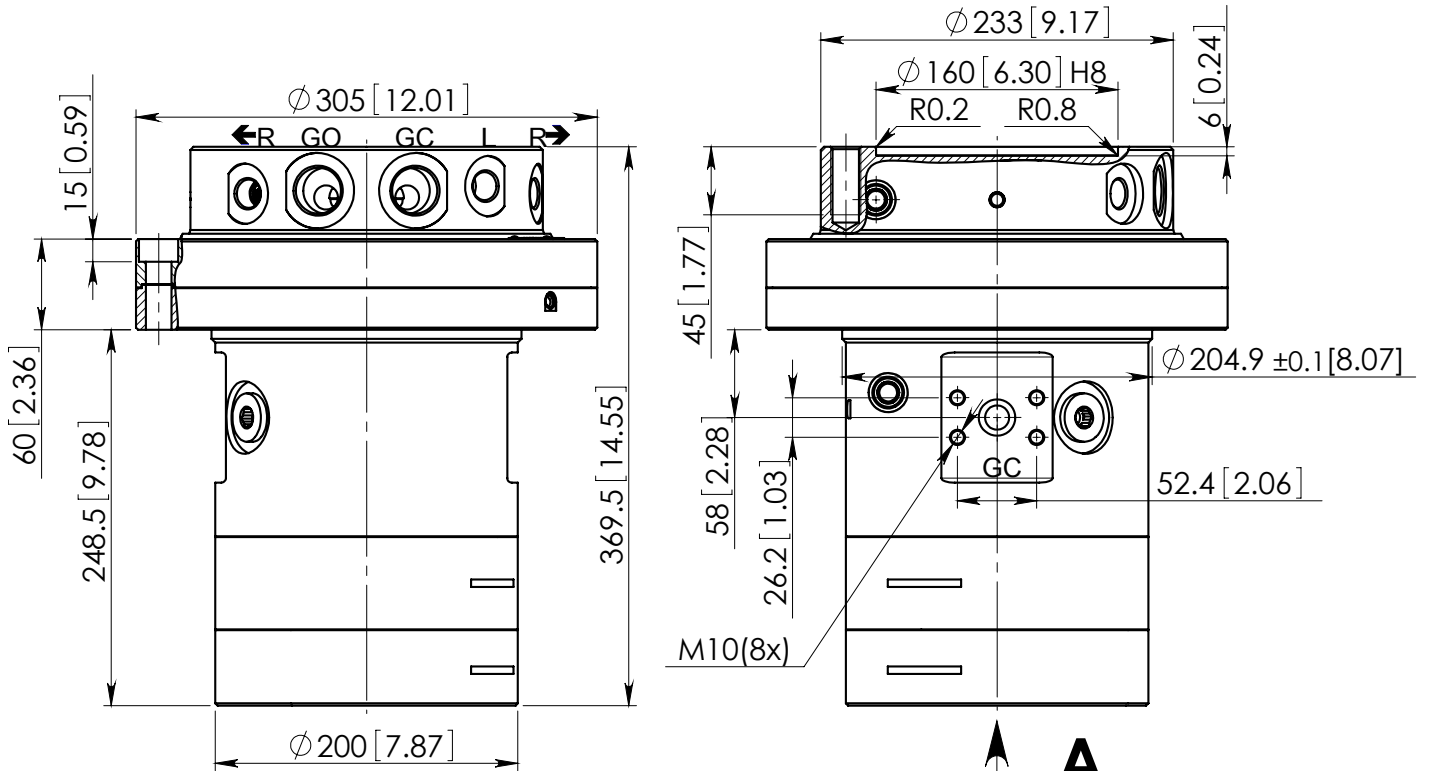

Technical data

Rotation	Unlimited
Max axial load static	±250 KN (56202 lbf)
Max axial load dynamic	±80 KN (17985 lbf)
Torque at 20 Mpa	2000 Nm (1475 lb ft)
Rated displacement	724 cm ³ /rev. (44.2 in ³ /rev.)
Rotation speed	max 30 rpm
Oil duct area for grapple	200 mm ² (0.31in ²)
Weight	102 kg (225 lb)

Function	Max working pressure	Rec oilflow	Connection
R - rotation	21 MPa (3045 psi)*	25 l/min (6.6 gal(US)/min)	G 1/2"
GO - grapple/tool open	32 MPa (4640 psi)*		G 1"; SAE 1"
GC - grapple/tool close	32 MPa (4640 psi)*		G 1"; SAE 1"
L - extra oil funktion	10 MPa (1450 psi)		G 1/2"; G 3/8"

* Relief valves fitted